

REDUCED WIRE-TO-WIRE AND JUNCTION BOX

201-01-172

1. SPECIFICATION DISTRIBUTION

No restrictions for issue

2. SCOPE

This specification contains the application notes for the 9286 poke home wire to wire connector. Both thru wire and junction box versions are included.

3. PRODUCTS

00-9286-00X-203-X06 thru wire connectors, (connects pairs of wires) standard colour white.
00-9286-00X-253-X06 junction box connectors (shorts all wires together) standard colour red.

For wire details refer to product specification 201-01-132.

Note: The connectors in this product series are available in standard white (thru wire version) and red (junction box version).

The colours used in this document are for illustration purposes only.

4. PRODUCT RANGE

4.1. THRU WIRE CONNECTORS



Available in 1, 2, 3, 4, 5 and 6 way sizes.



4.2. JUNCTION BOX CONNECTORS



Available in 4, 6 and 8 way options.

5. INTERNAL CONNECTIONS
5.1. THRU WIRE CONNECTOR

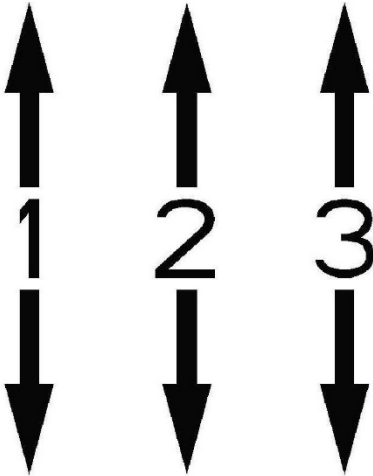

Thru wire connector, internal connection allows a pair of wires – one wire in to one wire out connection only. Each connection is numbered to assist with identification. Connectors available to link 1, 2, 3, 4, 6 and 8 pairs of wires. 3 way shown.

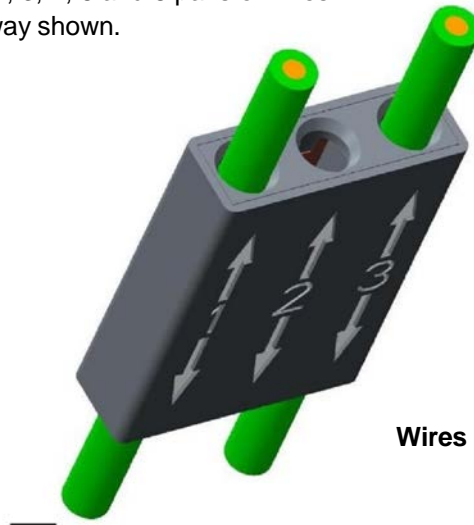

Wires in pairs, one in and one out.

5.2. JUNCTION BOX CONNECTOR

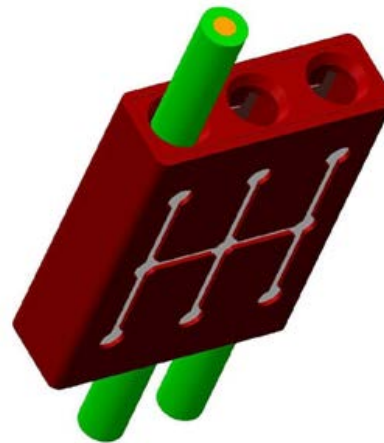
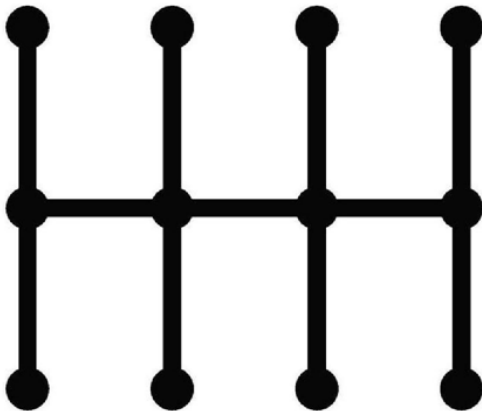

Junction box connector, internal connection between all wires in/out. Connectors available to inter-connect 4, 6 and 8 wires. 8 way shown.

Wires in any position, all interconnected.

6. WIRE INSERTION – ALL CONNECTORS

6.1. WIRE PREPERATION

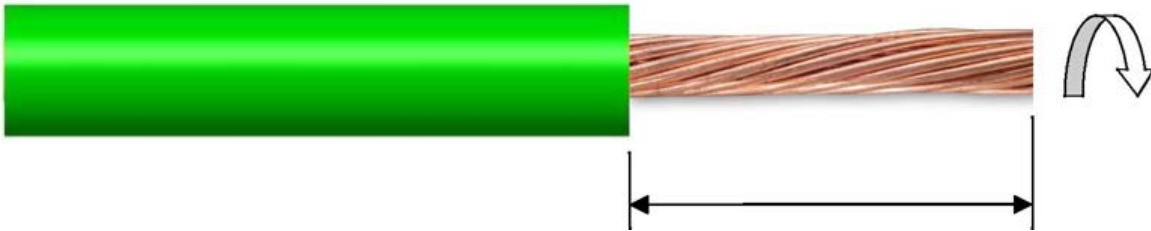

Insulation strip length 3.5mm to 4.5mm.
Stranded wire – recommended to twist wires together.

Note: for wires with insulation greater than 2.10mm diameter use a strip length 6.5mm to 7.5mm

6.2. WIRE INSERTION

1. Standard assembly, insert wires straight into positions required, insulator should always be under-flush with face of connector.
2. When using wire with insulation greater than 2.10mm diameter wire insulation will butt on face of connector.

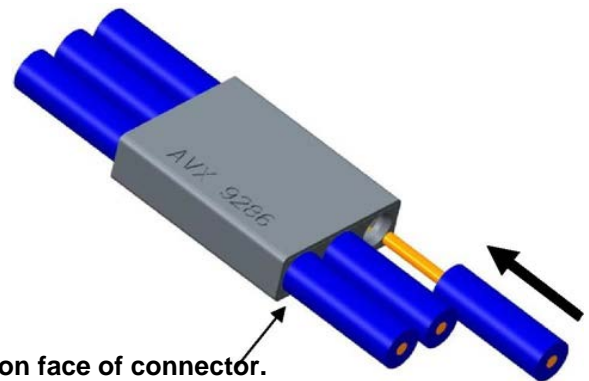
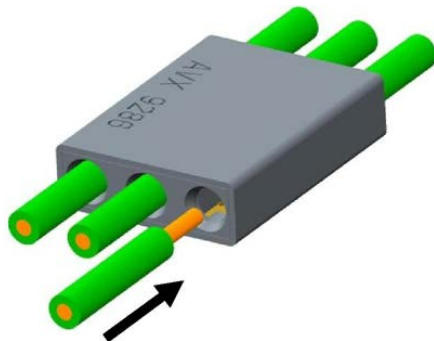

Wire insulation butts on face of connector.

7. WIRE EXTRACTION

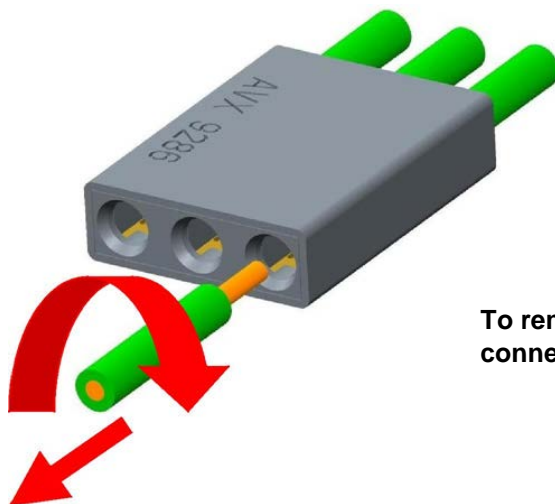

To remove a wire twist and pull in line with connector until wire is free.